

# AS-F2AD

# AS-F2DA

EN Instruction Sheet

TR Bilgi Dökümanı

TW 安裝說明

CN 安装说明



5014035402

2022-05-13



[www.deltaww.com](http://www.deltaww.com)



- EN ✘ This is an OPEN TYPE module and therefore should be installed in an enclosure free of airborne dust, humidity, electric shock and vibration. The enclosure should prevent non-maintenance staff from operating the device (e.g. key or specific tools are required for operating the enclosure) in case danger and damage on the device may occur.
- FR ✘ Ceci est un module ouvert et il doit donc être installé dans un coffret à l'abri des poussières, des vibrations et ne pas être exposé aux chocs électriques. Le boîtier ou l'armoire doit éviter toute action d'un personnel autre que celui affecté à la maintenance de l'appareil (par exemple, clefs, outils spécifiques pour l'ouverture du coffret), ceci afin d'éviter tout accident corporel ou endommagement du produit).
- TR ✘ Bu ürün AÇIK TİP bir modül olup toz, rutubet, elektrik şoku ve titreşimden uzak kapalı yerlerde muhafaza edilmelidir. Yanlış kullanım sonucu ürünün zarar görmesini önlemek için yetkili olmayan kişiler tarafından ürüne müdahale edilmesini önleyecek koruyucu önlemler alınmalıdır. (Ürünün bulunduğu panoya kilit konulması gibi).
- TW ✘ 本機為開放型 (OPEN TYPE) 機種，因此使用者使用本機時，必須將其安裝於具防塵、防潮及免於電擊/衝擊意外之外殼配線箱內。另必須具備保護措施 (如：特殊之工具或鑰匙才可打開) 防止非維護人員操作或意外衝擊本體，造成危險及損壞。
- CN ✘ 本机为开放型 (OPEN TYPE) 机种，因此使用者使用本机时，必须将其安装于具防尘、防潮及免于电击/冲击意外的外壳配线箱内。另必须具备保护措施 (如：特殊的工具或钥匙才可打开) 防止非维护人员操作或意外冲击本体，造成危险及损坏。

EN Please refer to the AS Series Hardware and Operation Manual for more information.

TR Daha fazla bilgi için lütfen AS Serisi Donanım ve Kullanım Klavuzuna bakınız.

TW 詳細資料請參考 AS 系列硬體及操作手冊

CN 详细资料请参考 AS 系列硬件及操作手冊

EN Assembly

TR Montaj

TW 安裝

CN 組裝

EN Installation: Put the extension card directly into the extension card slot until hearing a click.

Removal: Press , and pull out the extension card.

TR Kurulum : Genişleme kartını doğrudan genişleme kart yuvasına klik sesi duyuncaya kadar itiniz.

Çıkarma :  basınız ve genişleme kartını çekiniz.

TW 安裝：將擴充卡直接放入擴充卡槽直至喀一聲。

拆卸：按壓  處，並將擴充卡抽出。

CN 安裝：將擴充卡直接放入擴充卡槽直至喀一聲。

拆卸：按壓  處，並將擴充卡抽出。

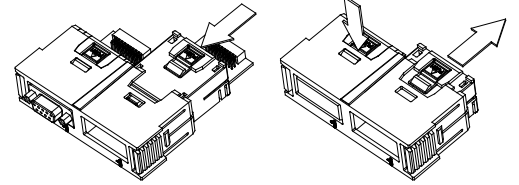

EN Dimensions(mm)

TR Ölçüler(mm)

TW 尺寸 (mm)

CN 尺寸 (mm)

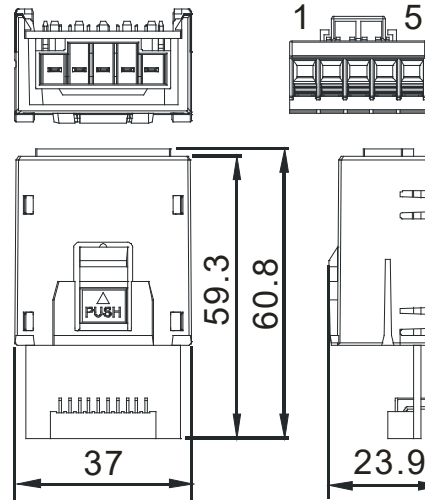

EN Pin definition

TR Pin açıklama

TW 接腳定義

CN 引脚定义

Pin no.	AS-F2AD	AS-F2DA
1	V1+	VO1
2	I1+	IO1
3	V2+	VO2
4	I2+	IO2
5	COM	COM

AS-F2AD

EN Input	TR Girişler	TW 輸入	CN 輸入
EN 2 analog signal input channels with 12-bit resolution: 0~10V/11-bit resolution: 4~20mA. Conversion time: 3ms/channel ※The analog signal input channel is "closed" by default. If necessary, please go to HWCONFIG in the ISPSOFT for set up.	TR 2 analog sinyal giriş kanalı: 0~10V 12-bit çözünürlük, 4~20mA 11-bit çözünürlük. Çevrim zamanı: 3ms/kanal ※Analog sinyal giriş kanalı varsayılan olarak "kapalı" (closed) şeklindedir. Ayar yapmak için lütfen ISPSOFT içerisindeki HWCONFIG kullanın.	TW 2 通道類比信號輸入 · 12 位元解析度: 0~10V · 11 位元解析度: 4~20mA · 轉換時間: 3ms/通道 ※類比輸入通道預設為關閉, 若需開啟, 請使用軟體的 HWCONFIG 進行設定。	CN 2 信道模拟信号输入 · 12 位分辨率: 0~10V · 11 位分辨率: 4~20mA · 转换时间: 3ms/通道 ※模拟输入通道默认为关闭, 若需开启, 请使用软件的 HWCONFIG 进行设定。

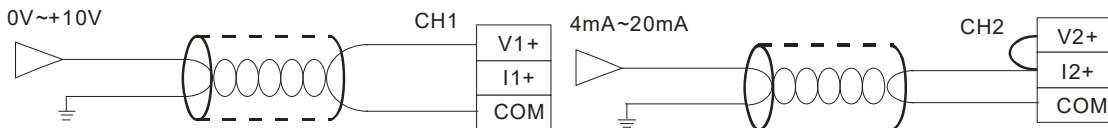

AS-F2DA

EN Output	TR Çıkış	TW 輸出	CN 輸出
EN 2 analog signal output channels with 12-bit resolution: 0~10V · 4~20mA. Conversion time: 2ms/channel	TR 2 analog sinyal çıkış kanalı: 0~10V · 4~20mA 12-bit çözünürlük. Çevrim zamanı: 2ms/kanal	TW 2 通道類比信號輸出 · 12 位元解析度: 0~10V · 4~20mA · 轉換時間: 2ms/通道	CN 2 信道模拟信号输出 · 12 位分辨率: 0~10V · 4~20mA · 转换时间: 2ms/通道

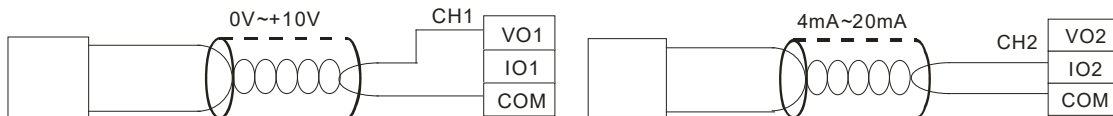

Part Name	Hazardous Substances						Industrial Automation Headquarters Delta Electronics, Inc.	
	Pb	Hg	Cd	Cr VI	PBB	PBDE		
Metal Part	X	O	O	O	O	O	<b>Delta Greentech (China) Co., Ltd.</b> 238 Min-Xia Road, Pudong District, Shanghai, P.R.C. 201209 TEL: 86-21-5863-5678 / FAX: 86-21-5863-0003	
Plastic Part	O	O	O	O	O	O		
Electronic	X	O	O	O	O	O		
Contacts	O	O	X	O	O	O		
Cabling accessories	X	O	O	O	O	O	<b>Industrial Automation Headquarters Delta Electronics, Inc.</b> Taoyuan Technology Center No.18, Xinglong Rd., Taoyuan District, Taoyuan City, 33068, Taiwan TEL: 886-3-362-6301 / FAX: 886-3-371-6301	
Battery	O	O	O	O	O	O		
本表格依据 SJ/T 11364 的规定编制。 O: 表示该有害物质在该部件所有均质材料中的含量均在 GB/T 26572 规定的限量要求以下。 X: 表示该有害物质在该部件的某一均质材料中的含量超出 GB/T 26572 规定的限量要求。 This table is made according to SJ/T 11364. O: Indicates that the concentration of hazardous substance in all of the homogeneous materials for this part is below the limit as stipulated in GB/T 26572. X: Indicates that concentration of hazardous substance in at least one of the homogeneous materials used for this part is above the limit as stipulated in GB/T 26572.							<b>台達電子工業股份有限公司</b> 機電事業群 地址: 33068 桃園市桃園區興隆路 18 號 電話: 886-3-3626301 傳真: 886-3-3716301 <b>中達電通股份有限公司</b> 地址: 上海市浦東新區民夏路 238 號 郵編: 201209 電話: (021) 5863-5678 傳真: (021) 5863-0003	
本手册内容若有變更, 恕不另行通知。 * 本手册内容若有变动, 恕不另行通知。							<b>EMEA</b> EMEA Headquarters: Delta Electronics (Netherlands) B.V. Sales: Sales.IA.EMEA@deltaww.com Marketing: Marketing.IA.EMEA@deltaww.com Technical Support: iatechnicalsupport@deltaww.com Customer Support: Customer-Support@deltaww.com TEL: +31(0)40 800 3900 TEL: +31(0)40 800 3900 <b>BENELUX: Delta Electronics (Netherlands) B.V.</b> Automotive Campus 260, 5708 JZ Helmond, The Netherlands Mail: Sales.IA.Benelux@deltaww.com TEL: +31(0)40 800 3900 <b>DACH: Delta Electronics (Netherlands) B.V.</b> Coesterweg 45, D-59494 Soest, Germany Mail: Sales.IA.DACH@deltaww.com TEL: +49(0)2921 987 0 <b>France: Delta Electronics (France) S.A.</b> ZI du bois Challand 2, 15 rue des Pyrénées, Lisses, 91090 Evry Cedex, France Mail: Sales.IA.FR@deltaww.com TEL: +33(0)1 69 77 82 60 <b>UK: Delta Electronics Europe Ltd.</b> 1 Redwood Court, East Kilbride, Glasgow, G74 5PF, United Kingdom TEL: +44-1355-588-888	
Asia <b>China: Delta Electronics (Shanghai) Co., Ltd.</b> No.182 Minyu Rd., Pudong Shanghai, P.R.C. Post code: 201209 TEL: +86-21-5872-3988 / FAX: +86-21-6872-3996 Customer Service: 400-820-9595 <b>Japan: Delta Electronics (Japan), Inc.</b> Industrial Automation Sales Department 2-1-14 Shibadaimon, Minato-ku Tokyo, Japan 105-0012 TEL: +81-3-5733-1155 / FAX: +81-3-5733-1255 <b>Korea: Delta Electronics (Korea), Inc.</b> 1511, 219, Casan Digital 1-Ro., Geumcheon-gu, Seoul, 08501 South Korea TEL: +82-2-515-5305 / FAX: +82-2-515-5302 <b>Singapore: Delta Energy Systems (Singapore) Pte Ltd</b> 4 Kaki Bukit Avenue 1, #05-04, Singapore 417939 TEL: +65-6747-5155 / FAX: +65-6744-9228 <b>India: Delta Electronics (India) Pvt. Ltd.</b> Plot No.43, Sector 35, HSIIDC Gurgaon, PIN 122001, Haryana, India TEL: +91-124-4874900 / FAX: +91-124-4874945							<b>Thailand: Delta Electronics (Thailand) PCL.</b> 909 Soi 9, Moo 4, Bangpoo Industrial Estate (E.P.Z), Pattana 1 Rd., T.Phraksa, A.Muang, Samutprakam 10280, Thailand TEL: +66-2709-2800 / FAX: +66-2709-2827 <b>Australia: Delta Electronics (Australia) Pty Ltd.</b> Unit 20-21/45 Normanby Rd., Notting Hill Vic 3168, Australia TEL: +61-3-9543-3720 <b>Americas</b> <b>USA: Delta Electronics (Americas) Ltd.</b> 5101 Davis Drive, Research Triangle Park, NC 27709, U.S.A. TEL: +1-919-767-3813 / FAX: +1-919-767-3969 <b>Brazil: Delta Electronics Brazil Ltd.</b> Estrada Velha Rio-São Paulo, 5300 Eugênio de Melo - São José dos Campos CEP:12247-004-SP- Brazil TEL: +55-12-3932-2300 / FAX: +55-12-3932-237 <b>Mexico: Delta Electronics International Mexico S.A. de C.V.</b> Gustavo Baz No. 309 Edificio E PB 103 Colonia La Loma, CP 54060 Tlalnepanita, Estado de México TEL: +52-55-3603-9200	<b>Iberia: Delta Electronics Solutions (Spain) S.L.U</b> Ctra. De Villaverde a Vallecas, 265 1º Dcha Ed. Hormigueras - P.I. de Vallecas 28031 Madrid TEL: +34(0)91 223 74 20 Carrer Llacuna 166, 08018 Barcelona, Spain Mail: Sales.IA.Iberia@deltaww.com <b>Italy: Delta Electronics (Italy) S.r.l.</b> Via Meda 2-22060 Novedrate(CO) Piazza Grazioli 18 00186 Roma Italy Mail: Sales.IA.Italy@deltaww.com TEL: +39 039 8900365 <b>Russia: Delta Energy System LLC</b> Vereskaya Plaza II, office 112 Vereskaya str. 17 121357 Moscow Russia Mail: Sales.IA.RU@deltaww.com TEL: +7 495 644 3240 <b>Turkey: Delta Greentech Elektronik San. Ltd. Sti. (Turkey)</b> Serifali Mah. Hendem Cad. Kule Sok. No:16-A 34775 Ümraniye - İstanbul Mail: Sales.IA.Turkey@deltaww.com TEL: +90 216 493 9910 <b>MEA: Eltek Dubai (Eltek MEA DMCC)</b> OFFICE 2504, 25th Floor, Saba Tower 1, Jumeirah Lakes Towers, Dubai, UAE Mail: Sales.IA.MEA@deltaww.com TEL: +971(0)4 2690148
*We reserve the right to change the information in this instruction sheet without prior notice.								